

Colorsteel Endura roofing on Thermakraft 215 underlay on H1.2 70x45 SG8 purlins on H1.2 140x45 SG8 dummy rafters with R4.0 Pink Batts [wall] insulation between over Thermakraft Vapor-Shield 101 over H3.1 35mm Lockwood solid timber sarking.

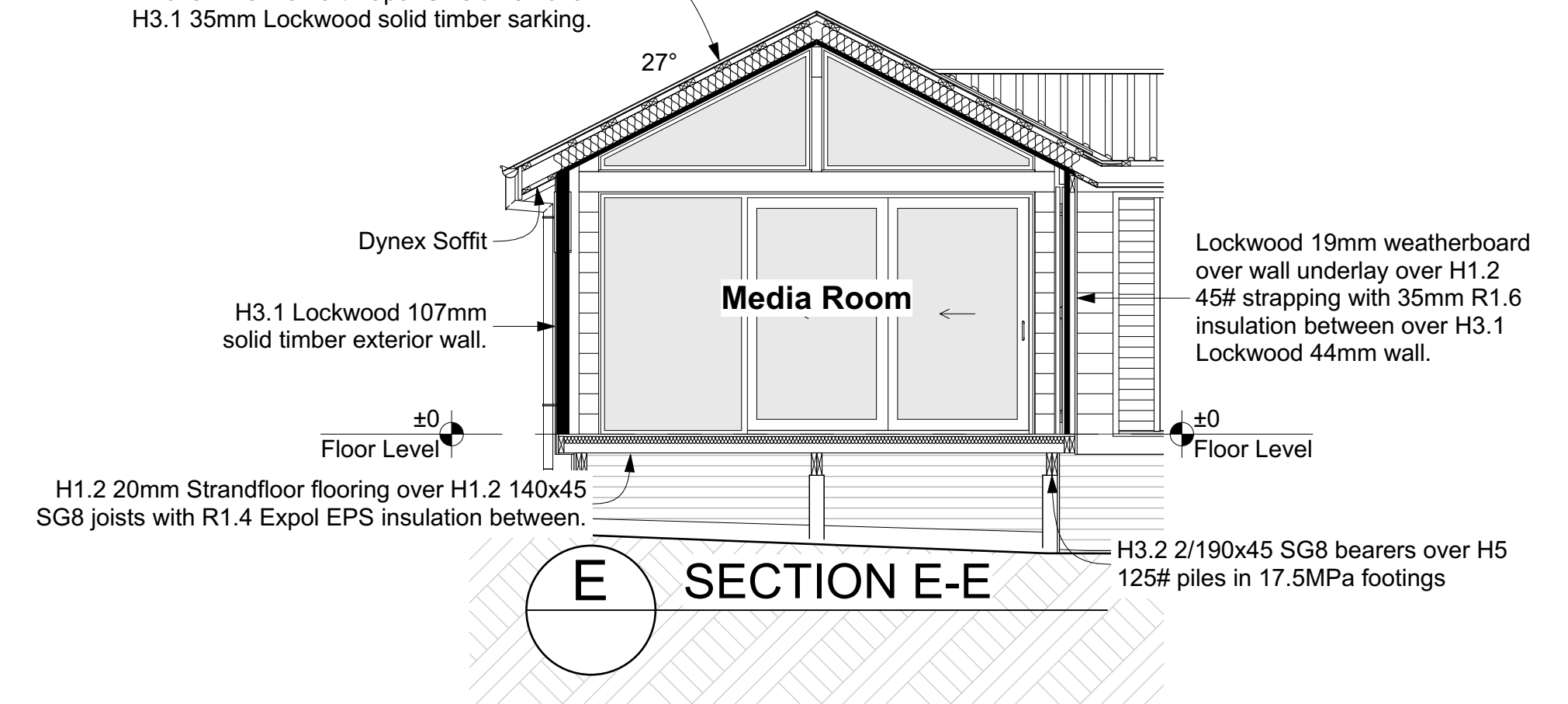

Floor Area:	141.70 m2	Sheet: 4/14
Scale:	1:50, 1:75 @ A2	
House Type:	Design and Build	
Drawing Type:		
Elevations & Sections		
Job Number:		
L19067		
© All plans copyright Lockwood		