

Pinevine

Contents

Welcome Tim and Karen de Roo – Lockwood Taupo..... 1

CodeMark latest certification requirements 2

Marama Davidson tours our facilities... 2

Altus Sill Protectors - now available 3

Closing dates in December..... 3

Lockwood Colours Upgrade..... 3

Vegepod November Promo 4

Rotorua Museum - Lockwood Youth Art Award 4

Lockwood NZ Aria Winners crowned . 5

Featured home in December 5

128m² Seaview Plan released..... 6

News from the Technical Department . 7

Welcome Tim and Karen de Roo – Lockwood Taupo

Tim and Karen are no strangers to Lockwood, having been involved with Lockwood Taupo for many years.

Tim started as a builders labourer with Lockwood Taupo all the way back in 2001 and soon after that commenced his apprenticeship.

He has spent years building stunning Lockwood Homes all around the Lake Taupo and the Central Plateau area.

He has been a qualified builder for 13 years and his role in the company will be focused on working with clients through their initial design stages, right through the construction to handover, ensuring their homes meet the highest standards.

Karen will be working closely with clients throughout the build process, looking after administration and assisting with project management. Karen has been a recipient of the Lockwood Customer Services Excellence award previously and is quite the ace on SugarCRM.



Tim has also worked for other building companies over the years which has provided him a broad range of knowledge and expertise in the building industry as a whole.

We are very happy to have them on board as [our contractors for Taupo](#). The Acacia show home will be open for business again very shortly and they will be operating from the offices on the same site.



Everyone wishes you both well Tim and Karen, and don't hesitate to pick up the phone for assistance here at Lockwood HQ or within the wider network. There is a lot of skill and contracting expertise to be tapped into and we know everyone will enjoy sharing it with you.

Current Production Lead Times

Current lead times when placing a final order (all milestones met, order approved for production)

Non-complex or Complex designs up to 120m² please allow 6 – 8 weeks from approved for production date

Non-Complex Designs over 120m² allow 8-9 weeks

For large or complex designs please check with the production team for more accurate lead times.

Please remember it is essential that all orders are complete, with all signed documentation etc. in place.

CodeMark latest certification requirements

We have received our latest certificate after successfully completing our CodeMark audit. It is important that you reference the correct certificate, with its respective terms and conditions. CodeMark certificates are issued every three years and this new one superseded the old version. It is loaded up onto the website under accreditations. [Click here to view..](#) Alternatively it can be found on the Extranet>Technical>Codemark>“Codemark Certificate 30044 RevH.pdf”



Marama Davidson tours our facilities

Co-leader of the Green Party and spokesperson for housing and regional economic development, Marama Davidson, toured our facilities and enjoyed finding out about the features and benefits of our building system.

It was great to have the opportunity to show her around and introduce her to the Lockwood team.



Altus Sill Protectors - now available



Altus Sill Protectors safeguard door sills against damage during the building process. Designed to fit snugly without disrupting the opening and closing of doors and sturdy enough for heavy foot traffic, they are made to last the entire duration of the construction. The sill protectors are simply clipped on and when construction is complete, they can be upclipped and used on the next project.

Altus Sill Protectors are now available for the Weathertight joinery suite. We have identified which protectors are most common to the Lockwood joinery offering and these are now available for purchase via the sundry order system.

SKU	Item	B Door	Z6 Slider	Z3 both opening panels	All Bifolds
M31381	Bevelled stacker			2 metres	
M31382	Bevelled slider		1 metre	2 metres	
M31392	B door Upstand	1 metre	1 metre	2 metres	2 metres
M31383	Stacker upstand			2 metres	
M31385	B door cover	1 metre			2 metres
Trade Price		\$15	\$15	\$30	\$30

Closing dates in December

Our December shut dates will be from midday on the 20th of December, re-opening on Monday the 13th of January.

Show homes will be shut between Christmas and New Year.

Please ensure that we have your dates for December and reopening so we can update the website and Google Business listings with this info.



Lockwood Colours Upgrade

Our interactive online tool just had a smart 360° upgrade.

Don't forget to go take a look and see how easy and interactive the new tool is. Visit lockwoodcolours.co.nz to help clients visualise their best colour options for their new home.

Vegepod November Promo

We are currently offering the chance to win a Medium Vegepod with Stand for anyone visiting a show home in November.

The value of the Vegepod is \$410. We have also been promoting across our social channels, so don't forget to tag your visitors in the CRM for the chance to win.

The t's and c's and more info for the public can be found at lockwood.co.nz/terms



Rotorua Museum - Lockwood Youth Art Award



Lockwood Youth Award Winner Bree Straker with Andrew La Grow

Lockwood were thrilled to be part of the awards, nurturing young talent with a new Youth Category. We congratulate Bree Straker, our first Lockwood Youth Award Winner!

Bree was awarded this \$1000 prize for her artwork Ruby, as shown here. "This work's carefully sculpted paint shows that this young woman understands the manipulation of paint to create the illusion of form," says Ms Wilson, the Judge with the unenviable task of choosing the finalists and winners.

They were chosen using a blind judging process, based purely on the merits of the artworks. Judge Leafa Wilson, a highly regarded New Zealand art curator, artist and

writer says she knew that the Bay of Plenty had a rich art tradition and this was reflected in this year's entries. "The breadth of media and subject matter always makes it difficult to compare any aspect of one work to another let alone choose one work over another. However, there are a number of works which stand out aesthetically, through the mauri and conceptual strength and for the artists approach to their subject," explained Ms Wilson.

Rotorua Museum Operations Manager, Cat Jehly, said this year they received the highest number of entries, with 188 artworks from 149 artists. "The huge interest in this year's competition really highlights the importance of the art awards and the need to support the wealth of artistic talent across the Bay of Plenty."



"Ruby" Bree Straker's winning artwork

Lockwood NZ Aria Winners crowned



Winner Elizabeth Mandeno with Andrew La Grouw

The New Zealand Aria is one of Australasia's most prestigious singing competitions. The event has been in existence for over 70 years. The competition offers life-changing opportunities to entrants and has launched the careers of some fine young singers. Lockwood Homes is a platinum sponsor this year and has acquired naming rights to the event and is proud to be associated with the development of young operatic talent.

After competing in the heats during the week, the top 10 finalists performed their arias to a packed Destiny Auditorium in Rotorua on Saturday evening, the 2nd of November. The competition standard was exceptionally high and the Auckland Philharmonia Orchestra was superb in their accompaniment.

Elizabeth Mandeno, from Auckland, took out first place in a field of 40 entrants, from New Zealand, Australia and the United States. She won the 1st prize, The Dame Malvina Major Foundation Award, which is calculated from the highest aggregates achieved for Compulsory Classes.

Her prize consisted of a \$20,000 package including, \$10,000 cash \$5,000 towards tuition or audition fees and \$5,000 Towards entry in the Sydney Eisteddfod Aria in Sydney

The second prize, The Geyser Community Foundation La Grouw Award* a \$10,000 prize was awarded to Ayako Ohtake. The \$5000 Coombes Johnston BMW Prize was awarded to Kirsten Jones, who placed 3rd on the night.

Featured home in December



John Hodges built a gorgeous Lockwood holiday home based on the Tobago plan for his clients Moodie-Stephens out on Spencer Rd at Lake Tarawera. They were recommended to him by the next door neighbours, who also built a gorgeous Lockwood with magnificent lake views not long before.

We were able to have their home photographed and it will be featured as our lead story for holiday home inspiration next month. Anna Moodie provided some wonderful feedback to us on the build journey to incorporate into the story. Anna says

“John is one of the old-school builders who takes pride in his work and is scrupulously honest and unbelievably hard working...”

Featured home in December Cont.

...I trust him absolutely and would recommend him without hesitation. Did you know that he and his wife do their own post-construction house cleaning on each home he builds – so that he knows that they have been cleaned of all construction mess and are delivered to a standard that he himself would live in? He has the keys to this place and he still pops out to sort any issues (there have been very few) or to let contractors in for us when we need him too.”

Way to go John, great feedback for us to write a story about their home building journey and no doubt a fierce Lockwood advocate for our brand and product as well as yourself.

Here are a couple of sneak preview pics of the home.



128m² Seaview Plan released

The [Seaview ReadyBuilt plan](#) was released this month and has been made available to the Lockwood Contracting network for on-site building. It features a central gable roofline, a nice addition to the other monopitched designs in the ReadyBuilt range.

If you missed this notification, you can find the info on the Extranet. A network brochure is saved to Marketing>Brochures and Flyers>Generic ReadyBuilt design flyers for on-site builds. Pricing has also been listed under Pricing>Plan Range Pricing>ReadyBuilt Special offer.pdf

News from the Technical Department

Stellar doors

To avoid possible bowing and movement on SR17 (blank door) offer a standard light colour range only.

Colours available (SR17 only)

- Arctic white satin GA145A
- Appliance white matt GA244A
- Titania matt GA275A
- Pale white satin GA154A
- Canvas satin GD142A
- OKeefe Grey satin GL117A
- Apo Ghost Grey satin GL183A
- Off white satin GD106A
- Almond satin GD160A
- Silver pearl satin GY120A

If a stellar door is a different colour from the other windows and doors, please use the order form notes section to highlight the colour difference and include any unique handle requirements.



Acoustic STC Rating

Sound transmission class has an updated reference available on the Extranet>Technical>product information. The reference also includes useful State Highway Mitigation advice.

Order Forms

As part of order milestones please provide a physical printed copy of the signed floor plans and elevations (latest version). A printed set of the full plans are not required. Along with this, send a digital copy of the full Consent plans to allow specific LW printing at A2 /A3.

Refer to Extranet>Ordering>Lockwood Order Form combined.pdf

Specification Change

There has been a change to the Lockwood specification - Component number 9 (i)

C and D type Aluminium flashing baseboards option is now available. The costing department will be offering A & B as the standard costing with C and D baseboards as an optional extra. This is reflected in the Lockwood Standard Specification, Issue No: 16 which can be found on the Extranet>Technical>Lockwood Specifications

News from the Technical Department cont.

Thermakraft 101 Vapor Shield

Thermakraft Vapor Shield -101 Moisture Control roof underlay consists of a polyolefin woven fabric and polyolefin film coated both sides. It is laid as a moisture vapour barrier to keep sarking dry until the roof is fixed, then acts as a vapour control layer during its serviceable life.

Providing it is installed under the guidance of an LBP and in accordance with the Application and Installation Guidelines, it meets performance requirements of NZBC Clause B2, Durability (B2.3.1[a] 50 years), and 2.3.1 (b) 15 years, E2 External Moisture.

Thermakraft 101 Vapor Shield is now available as sundry order item which can be freighted to your address or loaded out with your job.

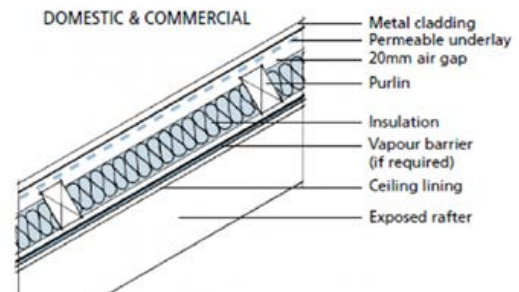

Field Reports

Field reports which were previously sent to Michelle are now to be sent to Stuart - stuartsteel@lockwood.co.nz.

“What are these for?”

Builders on site component guide

We have a put together guide for builders (especially new teams) to help identify Lockwood components that are not so obvious as to where they are used in the Lockwood building process. The two page document also has references to the detail manual for more information if required. A copy of the guide will go out with every job and it can also be accessed on the Extranet>Technical>Assembly Manuals.

We want to hear from you!

If you have any news, events, successes or challenges you would like to share with the network, please get in touch with Sarah (sarahsmith@lockwood.co.nz) so your stories can be included in the next issue.

A link to the Pinevine edition is available in .pdf version on the Extranet under Pinevine. Printed versions will be circulated to staff and mailed out to the network. If any of your staff would like to be added to the mailing list, let Sarah know.